

**SECOND FLOOR**

*Here is your cozy corner of the marina! This second floor suite has a free-flowing open concept layout with 3 private balconies!*

*You can choose your favourite tranquil spot, and take in all of the Marina's ambience in total privacy.*

*... Or let's work on a custom design that is perfect just for you!*

**SUITE 12**  
2450<sup>SQ</sup>FT\*

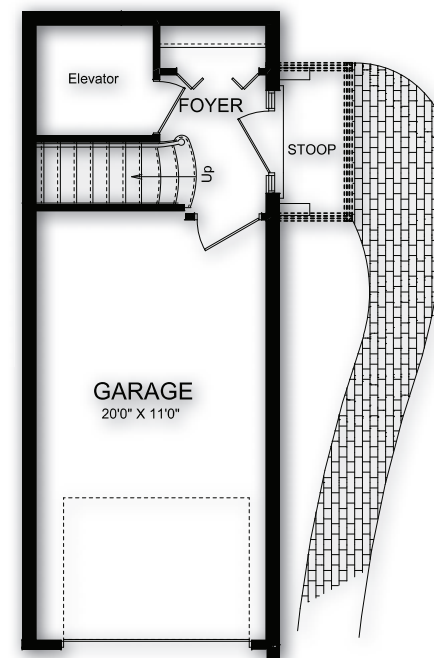

**GROUND FLOOR**



The "Island Series" will be a private, twin grouping of twelve gracious one-floor townhomes on the island. Choose a main floor home with large floor to ceiling windows or rise to the second floor in a state-of-the-art elevator to enjoy a spacious deck, over-looking your boat slip and the lake. The stone and stucco exteriors of these homes will be an eye-catching signature for this beautiful development and each will boast its own 2 private boat slips, back garden, and private rear and front balconies. Beautiful gardened areas surrounding the gazebo will offer a perfect spot to enjoy a glass of wine and just take it all in!

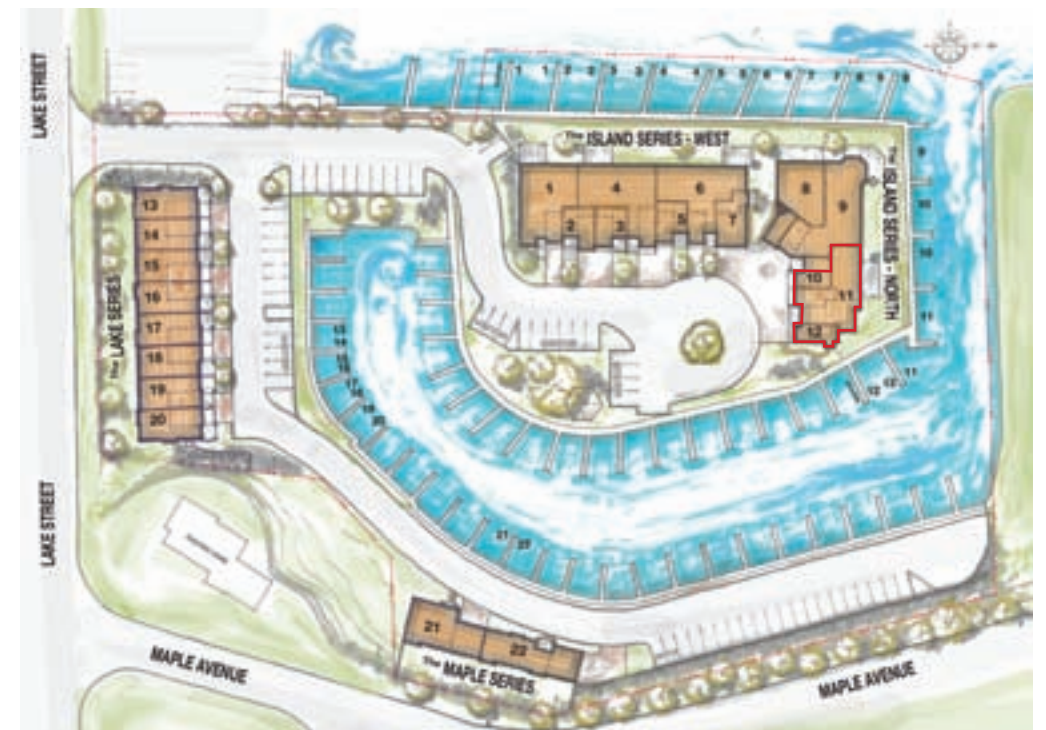

**Island Series North**

\*All dimensions are approximate. Sizes and specifications are subject to change without notice. E. & O.E. All illustrations are artist's concept. Actual useable floor space varies from stated floor area.